



RUSHMOOR BOROUGH COUNCIL

LICENSING SUB-COMMITTEE (ALCOHOL AND ENTERTAINMENTS)

*at the Council Offices, Farnborough on
Wednesday, 13th March, 2019 at 10.00 am*

To:

Cllr Liz Corps

Cllr B. Jones

Cllr Jacqui Vosper

Enquiries regarding this agenda should be referred to the Committee Administrator:
Chris Todd, Democracy, Strategy and Partnerships, Tel. (01252) 398825 or Email
chris.todd@rushmoor.gov.uk

A G E N D A

1. **DETERMINATION OF AN APPLICATION FOR A PREMISES LICENCE IN RESPECT OF NO. 58 STATION ROAD, ALDERSHOT – (Pages 1 - 30)**

To consider the Head of Operational Services' Report No. OS1901 (copy attached) setting out details of an application for a premises licence.

This page is intentionally left blank

LICENSING SUB-COMMITTEE
(ALCOHOL & ENTERTAINMENTS)
13 MARCH 2019

OPERATIONAL SERVICES

LICENSING REPORT NO. OS1901

**DETERMINATION OF AN APPLICATION FOR
A PREMISES LICENCE**

58 STATION ROAD ALDERSHOT HAMPSHIRE GU11 1BG

1.0 INTRODUCTION

- 1.1. This report concerns an application for a premises licence made under section 17 of the Licensing Act 2003 (the 'Act'). Representations have been received in respect of the application and invoke a statutory requirement to hold a hearing with members.
- 1.2. The report provides details of, and background to the application, and should be read in conjunction with the Council's licensing policy and Secretary of State's guidance. This, together with information obtained at the hearing should be used to determine the application.

2.0 BACKGROUND

- 2.1. An application for premises licence was submitted on 19th December 2018 by SK PVT Limited, in respect of the premises at 58 Station Road, Aldershot, GU11 1BG.
- 2.2. A map of the area showing the general location of the premises is given at **appendix A**.

2.3. Nature of the application

- 2.4. The application seeks to apply for the sale of alcohol on Monday's to Thursday's 12:00(midday) to 22:00pm and on Friday's to Sunday's 12:00(midday) to 23:00pm.

- 2.5. A copy of the application form is given at **appendix B**.

2.6. Advertising of the application

- 2.7. I can confirm that each responsible authority (as specified in the Act) has received a copy of the application. I can also confirm that the application was advertised by the applicant in accordance with the requirements of the legislation both at the premises and in a local newspaper. The last date for representations was given as the 16th January 2019.

3.0 REPRESENTATIONS

3.3. One representation by way of an objection has been received in respect of this application. This representation has been made by a responsible authority, namely The Licensing Authority. A copy of the representation is given at **appendix C**.

3.4. Relevance of Representation(s)

3.5. To be eligible to be considered, the Act requires a(ny) representation(s) to be '*relevant*'. A '*relevant representation*' is one that has been made by a responsible authority or any other person within the prescribed period permitted. Similarly, representations must not be frivolous or vexatious and must be about the likely effect of the grant of the licence on the promotion of the licensing objectives.

3.6. The licensing objectives are defined in the Act and include -

- (a) the prevention of crime and disorder;
- (b) ensuring public safety;
- (c) the prevention of public nuisance; and
- (d) the protection of children from harm.

3.7. Relevance of representations

3.8. Against the above criteria the representations are considered to be relevant as they were submitted within the prescribed period, by a responsible authority and concern all four of the licensing objectives; namely the prevention of crime and disorder, public safety, protection of children from harm and public nuisance.

4.0 DATA PROTECTION ISSUES

4.3. As a public document, any personal details, including addresses, contact details and/or signatures submitted on any application, representation or other document contained in this report have been redacted in accordance with data protection requirements.

5.0 DETERMINATION

5.3. Further to the receipt of relevant representations and, in accordance with the Act and the Council's scheme of delegation, the Sub-Committee is asked to determine the application.

6.0 RELEVANT CONSIDERATIONS

6.3. Licensing Objectives

6.4. In determination of the application, the licensing authority must have regard to the promotion of the licensing objectives. These are set out at paragraph 3.6 above.

6.5. Licensing policy & S182 Guidance

6.6. The licensing authority must also have regard to its statement of licensing policy and any guidance issued by the Secretary of State under section 182 of the Act. Details of the parts of the policy and guidance that may be relevant to this application are given in **appendix D** to this report.

7.0 OPTIONS

7.3. In determining this application, the Sub-Committee may take any of the following steps as it considers appropriate for the promotion of the licensing objectives; namely -

- (a) to grant the licence as applied for*; or
- (b) to reject the whole or part of the application.

** Subject to any relevant mandatory conditions, amendments agreed by the applicant and/or such other conditions that are consistent with the operating schedule which, with the exception of mandatory conditions, may be modified (which may include the alteration or omission of a condition or the addition of any new condition(s)) to such extent as may be necessary to promote the licensing objectives.*

8.0 RECOMMENDATION(S)

8.3. The Sub-Committee is asked to determine the application having regard to -

- (a) the contents of this report;
- (b) any additional information obtained from the hearing;
- (c) the Council's licensing policy;
- (d) guidance issued by the Secretary of State; and
- (e) the promotion of the licensing objectives.

AIMEE VOSSER
Licensing Officer
Operational Services
licensing@rushmoor.gov.uk

BACKGROUND PAPERS:

Premises licence application 18/01043/LAPRE

PUBLIC DOCUMENTS:

- 1) The Licensing Act 2003
- 2) Guidance issued under Section 182 of the Licensing Act 2003 (April 2018)

CONTACT:

Aimee Vosser, Licensing Officer

Tel: (01252) 398131, Email: aimee.vosser@rushmoor.gov.uk

APPENDICES:

Appendix	Description	Page Ref.
A	- Map of the area	Page 5
B	- Application Form	Page 7
C	- Representation – Licensing Authority	Page 27
D	- Relevant Considerations	Page 29

-oOo-

MAP OF THE AREA

58 STATION ROAD ALDERSHOT HAMPSHIRE GU11 1BG

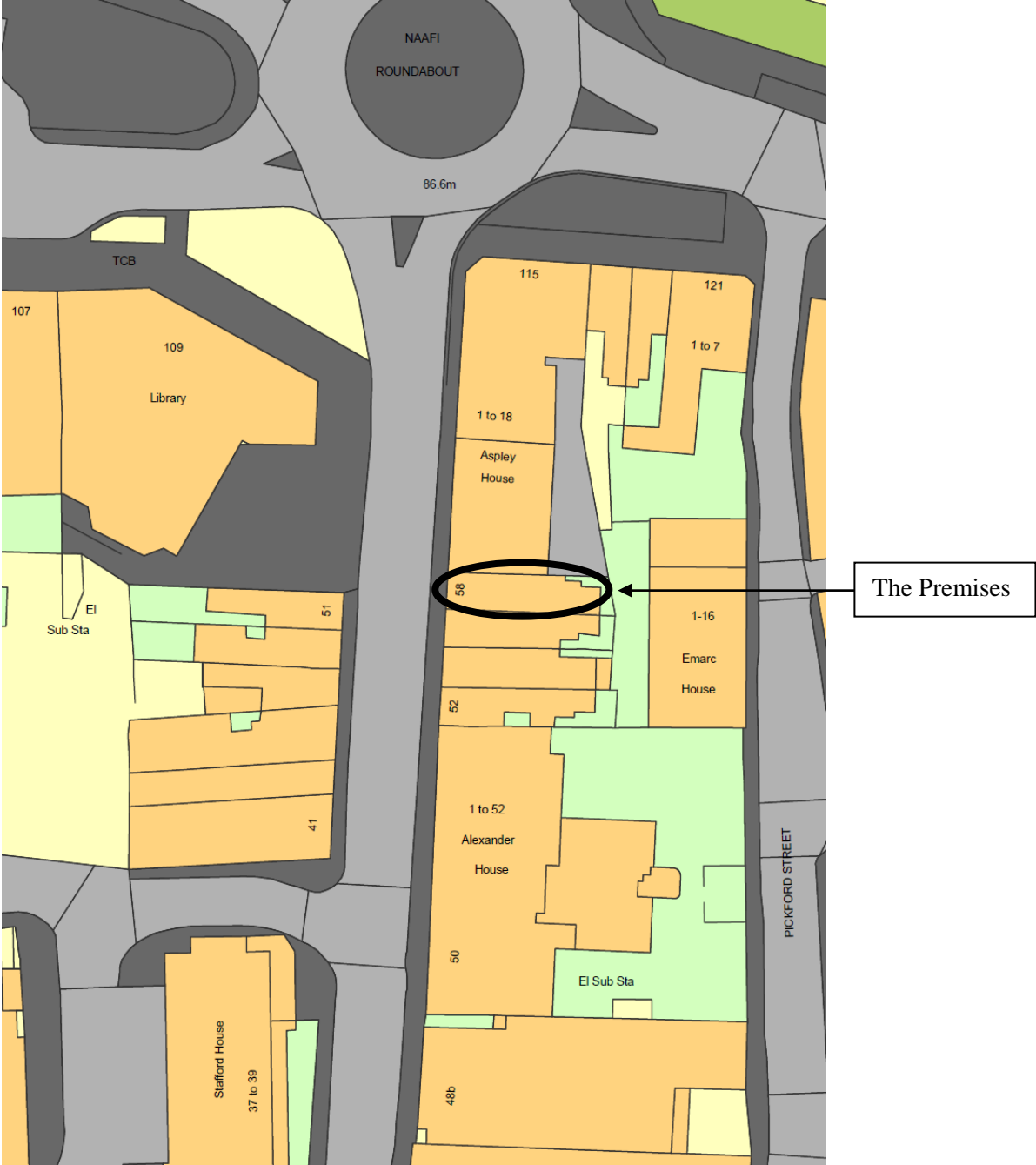

APPLICATION FORM

58 STATION ROAD ALDERSHOT GU11 1BG

Card / fee - £100.00
05016373

Application for a premises licence to be granted
under the Licensing Act 2003

PLEASE READ THE FOLLOWING INSTRUCTIONS FIRST

Before completing this form please read the guidance notes at the end of the form. If you are completing this form by hand please write legibly in block capitals. In all cases ensure that your answers are inside the boxes and written in black ink. Use additional sheets if necessary.

You may wish to keep a copy of the completed form for your records.

I/we SIC PVT Ltd Limited
(Insert name(s) of applicant)

apply for a premises licence under section 17 of the Licensing Act 2003 for the premises described in Part 1 below (the premises) and I/we are making this application to you as the relevant licensing authority in accordance with section 12 of the Licensing Act 2003

Part 1 - Premises details

Postal address of premises or, if none, ordnance survey map reference or description <u>58 STATION ROAD</u>			
Post town	<u>ALDERSHOT</u>	Postcode	<u>GU11 1BG</u>
Telephone number at premises (if any)	<u>01262 266864</u>		
Non-domestic rateable value of premises	£		

Part 2 - Applicant details

Please state whether you are applying for a premises licence as Please tick as appropriate

- a) an individual or individuals * please complete section (A)
- b) a person other than an individual *
 - i as a limited company/limited liability partnership please complete section (B)
 - ii as a partnership (other than limited liability) please complete section (B)
 - iii as an unincorporated association or please complete section (B)
 - iv other (for example a statutory corporation) please complete section (B)
- c) a recognised club please complete section (B)
- d) a charity please complete section (B)

- e) the proprietor of an educational establishment please complete section (B)
- f) a health service body please complete section (B)
- g) a person who is registered under Part 2 of the Care Standards Act 2000 (c14) in respect of an independent hospital in Wales please complete section (B)
- ga) a person who is registered under Chapter 2 of Part 1 of the Health and Social Care Act 2008 (within the meaning of that Part) in an independent hospital in England please complete section (B)
- h) the chief officer of police of a police force in England and Wales please complete section (B)

* If you are applying as a person described in (a) or (b) please confirm (by ticking yes to one box below):

- I am carrying on or proposing to carry on a business which involves the use of the premises for licensable activities; or
- I am making the application pursuant to a
 - statutory function or
 - a function discharged by virtue of Her Majesty's prerogative

(A) INDIVIDUAL APPLICANTS (fill in as applicable)

Mr <input type="checkbox"/>	Mrs <input type="checkbox"/>	Miss <input type="checkbox"/>	Ms <input type="checkbox"/>	Other Title (for example, Rev)	
Surname			First names		
Date of birth		I am 18 years old or over <input type="checkbox"/>		Please tick yes	
Nationality					
Current residential address if different from premises address					
Post town				Postcode	
Daytime contact telephone number					
E-mail address (optional)					

SECOND INDIVIDUAL APPLICANT (if applicable)

Mr <input type="checkbox"/>	Mrs <input type="checkbox"/>	Miss <input type="checkbox"/>	Ms <input type="checkbox"/>	Other Title (for example, Rev)	
Surname			First names		

Date of birth		I am 18 years old or over <input type="checkbox"/> Please tick yes	
Nationality			
Current postal address if different from premises address			
Post town		Postcode	
Daytime contact telephone number			
E-mail address (optional)			

(B) OTHER APPLICANTS

Please provide name and registered address of applicant in full. Where appropriate please give any registered number. In the case of a partnership or other joint venture (other than a body corporate), please give the name and address of each party concerned.

Name	SK PVT Limited
Address	58 STATION ROAD AUBURGH G70 1BG
Registered number (where applicable)	
Description of applicant (for example, partnership, company, unincorporated association etc.)	Company
Telephone number (if any)	
E-mail address (optional)	

Part 3 Operating Schedule

When do you want the premises licence to start?

DD	MM	YYYY
<input type="text"/>	<input type="text"/>	<input type="text"/>

If you wish the licence to be valid only for a limited period, when do you want it to end?

DD	MM	YYYY

Please give a general description of the premises (please read guidance note 1)

Restaurant

If 5,000 or more people are expected to attend the premises at any one time, please state the number expected to attend.

What licensable activities do you intend to carry on from the premises?

(please see sections 1 and 14 and Schedules 1 and 2 to the Licensing Act 2003)

Provision of regulated entertainment (please read guidance note 2)

Please tick all that apply

- a) plays (if ticking yes, fill in box A)
- b) films (if ticking yes, fill in box B)
- c) indoor sporting events (if ticking yes, fill in box C)
- d) boxing or wrestling entertainment (if ticking yes, fill in box D)
- e) live music (if ticking yes, fill in box E)
- f) recorded music (if ticking yes, fill in box F)
- g) performances of dance (if ticking yes, fill in box G)
- h) anything of a similar description to that falling within (e), (f) or (g) (if ticking yes, fill in box H)

Provision of late night refreshment (if ticking yes, fill in box I)

Supply of alcohol (if ticking yes, fill in box J)

In all cases complete boxes K, L and M



A

Plays Standard days and timings (please read guidance note 7)			Will the performance of a play take place indoors or outdoors or both – please tick (please read guidance note 3)	Indoors	<input type="checkbox"/>
				Outdoors	<input type="checkbox"/>
				Both	<input type="checkbox"/>
Day	Start	Finish	Please give further details here (please read guidance note 4)		
Mon					
Tue			State any seasonal variations for performing plays (please read guidance note 5)		
Wed					
Thur			Non standard timings. Where you intend to use the premises for the performance of plays at different times to those listed in the column on the left, please list (please read guidance note 6)		
Fri					
Sat					
Sun					

B

Films Standard days and timings (please read guidance note 7)			Will the exhibition of films take place indoors or outdoors or both – please tick (please read guidance note 3)	Indoors	<input type="checkbox"/>
				Outdoors	<input checked="" type="checkbox"/>
				Both	<input type="checkbox"/>
Day	Start	Finish			
Mon			Please give further details here (please read guidance note 4)		
Tue					
Wed			State any seasonal variations for the exhibition of films (please read guidance note 5)		
Thur					
Fri			Non standard timings. Where you intend to use the premises for the exhibition of films at different times to those listed in the column on the left, please list (please read guidance note 6)		
Sat					
Sun					

C

Indoor sporting events Standard days and timings (please read guidance note 7)			Please give further details (please read guidance note 4)
Day	Start	Finish	State any seasonal variations for indoor sporting events (please read guidance note 5)
Mon			
Tue			Non standard timings. Where you intend to use the premises for indoor sporting events at different times to those listed in the column on the left, please list (please read guidance note 6)
Wed			
Thur			
Fri			
Sat			
Sun			

D

Boxing or wrestling entertainments Standard days and timings (please read guidance note 7)			Will the boxing or wrestling entertainment take place indoors or outdoors or both – please tick (please read guidance note 3)		Indoors	<input type="checkbox"/>
					Outdoors	<input type="checkbox"/>
Day	Start	Finish				
Mon			Please give further details here (please read guidance note 4)			
Tue						
Wed			State any seasonal variations for boxing or wrestling entertainment (please read guidance note 5)			
Thur						
Fri			Non standard timings. Where you intend to use the premises for boxing or wrestling entertainment at different times to those listed in the column on the left, please list (please read guidance note 6)			
Sat						
Sun						

E

Live music Standard days and timings (please read guidance note 7)			Will the performance of live music take place indoors or outdoors or both – please tick (please read guidance note 3)		Indoors	<input type="checkbox"/>
					Outdoors	<input type="checkbox"/>
					Both	<input type="checkbox"/>
Day	Start	Finish				
Mon			Please give further details here (please read guidance note 4)			
Tue						
Wed			State any seasonal variations for the performance of live music (please read guidance note 5)			
Thur						
Fri			Non standard timings. Where you intend to use the premises for the performance of live music at different times to those listed in the column on the left, please list (please read guidance note 6)			
Sat						
Sun						

F

Recorded music Standard days and timings (please read guidance note 7)			Will the playing of recorded music take place indoors or outdoors or both – please tick (please read guidance note 3)	
			Indoors	<input type="checkbox"/>
			Outdoors	<input type="checkbox"/>
			Both	<input type="checkbox"/>
Day	Start	Finish		
Mon			Please give further details here (please read guidance note 4)	
Tue				
Wed			State any seasonal variations for the playing of recorded music (please read guidance note 5)	
Thur				
Fri			Non standard timings. Where you intend to use the premises for the playing of recorded music at different times to those listed in the column on the left, please list (please read guidance note 6)	
Sat				
Sun				

G

Performances of dance Standard days and timings (please read guidance note 7)			Will the performance of dance take place indoors or outdoors or both – please tick (please read guidance note 3)	Indoors	<input type="checkbox"/>
Day	Start	Finish		Outdoors	<input type="checkbox"/>
Mon			Please give further details here (please read guidance note 4)	Both	<input type="checkbox"/>
Tue					
Wed			State any seasonal variations for the performance of dance (please read guidance note 5)		
Thur					
Fri			Non standard timings. Where you intend to use the premises for the performance of dance at different times to those listed in the column on the left, please list (please read guidance note 6)		
Sat					
Sun					

~~H~~

Anything of a similar description to that falling within (e), (f) or (g) Standard days and timings (please read guidance note 7)			Please give a description of the type of entertainment you will be providing		
Day	Start	Finish	Will this entertainment take place indoors or outdoors or both – please tick (please read guidance note 3)	Indoors	<input type="checkbox"/>
Mon				Outdoors	<input type="checkbox"/>
				Both	<input type="checkbox"/>
Tue			Please give further details here (please read guidance note 4)		
Wed					
Thur			State any seasonal variations for entertainment of a similar description to that falling within (e), (f) or (g) (please read guidance note 5)		
Fri					
Sat			Non standard timings. Where you intend to use the premises for the entertainment of a similar description to that falling within (e), (f) or (g) at different times to those listed in the column on the left, please list (please read guidance note 6)		
Sun					

I

Late night refreshment Standard days and timings (please read guidance note 7)			Will the provision of late night refreshment take place indoors or outdoors or both – please tick (please read guidance note 3)	
Day	Start	Finish	Indoors	<input type="checkbox"/>
			Outdoors	<input type="checkbox"/>
			Both	<input type="checkbox"/>
Mon			Please give further details here (please read guidance note 4)	
Tue				
Wed			State any seasonal variations for the provision of late night refreshment (please read guidance note 5)	
Thur				
Fri			Non standard timings. Where you intend to use the premises for the provision of late night refreshment at different times, to those listed in the column on the left, please list (please read guidance note 6)	
Sat				
Sun				

J

Supply of alcohol Standard days and timings (please read guidance note 7)			Will the supply of alcohol be for consumption – please tick (please read guidance note 8)	On the premises	<input checked="" type="checkbox"/>
				Off the premises	<input type="checkbox"/>
Day	Start	Finish	Both <input type="checkbox"/>		
Mon	12.00	22.00	State any seasonal variations for the supply of alcohol (please read guidance note 5)		
Tue	12.00	22.00			
Wed	12.00	22.00			
Thur	12.00	22.00	Non standard timings. Where you intend to use the premises for the supply of alcohol at different times to those listed in the column on the left, please list (please read guidance note 6)		
Fri	12.00	23.00			
Sat	12.00	23.00			
Sun	12.00	23.00			

State the name and details of the individual whom you wish to specify on the licence as designated premises supervisor (Please see declaration about the entitlement to work in the checklist at the end of the form):

Name	DHIRENDRA KUMAR CHAMSONG LIMBO	
Date of birth		
Address		
Postcode		
Personal licence number (if known)	17/00962 / CAPEK	
Issuing licensing authority (if known)	Rushmoor BC	

□□□□

K

Please highlight any adult entertainment or services, activities, other entertainment or matters ancillary to the use of the premises that may give rise to concern in respect of children (please read guidance note 9).

N/A

L

Hours premises are open to the public Standard days and timings (please read guidance note 7)			State any seasonal variations (please read guidance note 5)
Day	Start	Finish	
Mon	12:00	22:00	Non standard timings. Where you intend the premises to be open to the public at different times from those listed in the column on the left, please list (please read guidance note 6)
Tue	12:00	22:00	
Wed	12:00	22:00	
Thur	12:00	22:00	
Fri	12:00	23:00	
Sat	12:00	23:00	
Sun	12:00	23:00	

M Describe the steps you intend to take to promote the four licensing objectives:

a) General – all four licensing objectives (b, c, d and e) (please read guidance note 10)

b) The prevention of crime and disorder

challenge QS + signage
Staff training - mainbaun records +
refresher training

c) Public safety

CCU covering public areas

d) The prevention of public nuisance

notices asking customers to leave quietly.

e) The protection of children from harm

Refusers log
Incident log

Checklist:

Please tick to indicate agreement

- I have made or enclosed payment of the fee.
- I have enclosed the plan of the premises.
- I have sent copies of this application and the plan to responsible authorities and others where applicable.
- I have enclosed the consent form completed by the individual I wish to be designated premises supervisor, if applicable.
- I understand that I must now advertise my application.
- I understand that if I do not comply with the above requirements my application will be rejected.
- [Applicable to all individual applicants, including those in a partnership which is not a limited liability partnership, but not companies or limited liability partnerships] I have included documents demonstrating my entitlement to work in the United Kingdom (please read note 15).

IT IS AN OFFENCE, UNDER SECTION 158 OF THE LICENSING ACT 2003, TO MAKE A FALSE STATEMENT IN OR IN CONNECTION WITH THIS APPLICATION. THOSE WHO MAKE A FALSE STATEMENT MAY BE LIABLE ON SUMMARY CONVICTION TO A FINE OF ANY AMOUNT.

IT IS AN OFFENCE UNDER SECTION 24B OF THE IMMIGRATION ACT 1971 FOR A PERSON TO WORK WHEN THEY KNOW, OR HAVE REASONABLE CAUSE TO BELIEVE, THAT THEY ARE DISQUALIFIED FROM DOING SO BY REASON OF THEIR IMMIGRATION STATUS. THOSE WHO EMPLOY AN ADULT WITHOUT LEAVE OR WHO IS SUBJECT TO CONDITIONS AS TO EMPLOYMENT WILL BE LIABLE TO A CIVIL PENALTY UNDER SECTION 15 OF THE IMMIGRATION, ASYLUM AND NATIONALITY ACT 2006 AND PURSUANT TO SECTION 21 OF THE SAME ACT, WILL BE COMMITTING AN OFFENCE WHERE THEY DO SO IN THE KNOWLEDGE, OR WITH REASONABLE CAUSE TO BELIEVE, THAT THE EMPLOYEE IS DISQUALIFIED.

Part 4 – Signatures (please read guidance note 11)

Signature of applicant or applicant's solicitor or other duly authorised agent (see guidance note 12). **If signing on behalf of the applicant, please state in what capacity.**

Declaration	<ul style="list-style-type: none"> [Applicable to individual applicants only, including those in a partnership which is not a limited liability partnership] I understand I am not entitled to be issued with a licence if I do not have the entitlement to live and work in the UK (or if I am subject to a condition preventing me from doing work relating to the carrying on of a licensable activity) and that my licence will become invalid if I cease to be entitled to live and work in the UK (please read guidance note 15). The DPS named in this application form is entitled to work in the UK (and is not subject to conditions preventing him or her from doing work relating to a licensable activity) and I have seen a copy of his or her proof of entitlement to work, if appropriate (please see note 15)
--------------------	--

Signature		
Date		
Capacity		

For joint applications For joint applications, the authorised agent must be a partner or other authorised agent of the applicant, please state in what capacity.

Signature		
Date		
Capacity		

Contact name (where not previously given) and postal address for correspondence associated with this application (please read guidance note 14)

DHRENDRA KUMAR CHENYONG LIMBU

Post town	ALD	
Telephone number (if any)		
If you would prefer us to contact you by email		

- Notes for Guidance**
- Describe the premises, for example the type of premises, its general situation and layout and any other information which could be relevant to the licensing objectives. Where your application includes off-supplies of alcohol and you intend to provide a place for consumption of these off-supplies, you must include a description of where the place will be and its proximity to the premises.
 - In terms of specific regulated entertainments please note that:

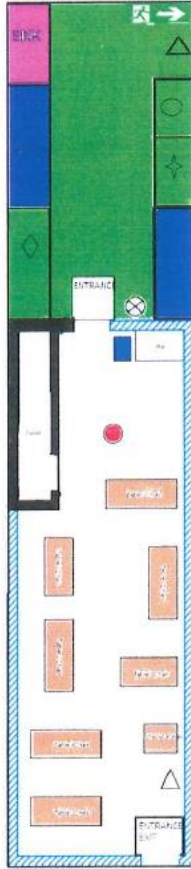

LEGEND	
	FIRE EXIT
	SINK
	KITCHEN COOKING AREA
	TABLE/CHAIR
	KITCHEN PREPARATION AREA
	FIRE ALARM
	BLANKET
	FIRE EXTINGUISHER
	PURPLE FIXTURES: FRIDGE
	STORAGE

Scale 1:100=1cm
denotes 1meter
1 = 1cm and 100 = meter

REPRESENTATION – THE LICENSING AUTHORITY

58 STATION ROAD ALDERSHOT HAMPSHIRE GU11 1BG

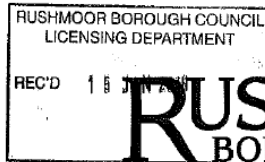

Council Offices, Farnborough Road,
Farnborough, Hants. GU14 7JU
Tel: (01252) 398 399
Website: www.rushmoor.gov.uk

Our Ref: 18/01043/LAPRE

Officer: Wendy Harden

Your Ref:

Tel: 01252 398245

The Licensing Authority

Email: wendy.harden@rushmoor.gov.uk

Date: 15th January 2019

Dear Sir / Madam,

THE LICENSING ACT 2003

**Representation in respect of an application for a premises licence
Gurkha Villa, 58 Station Road, Aldershot, Hampshire, GU11 1BG**

Individual making representations:

My name is Wendy Harden and I am employed as a Licensing Officer for Rushmoor Borough Council. I have been employed in this capacity on this occasion for approximately for two months, however have previously worked as a Licensing Officer for approximately 2.5 years. I also have 18 months experience as an Investigator for Gangmaster Labour and Abuse Authority and 12 years experience as a Police Officer. I hold a BIIAB National Certificate for Personal Licence holders, a BIIAB National Certificate for Licensing Practitioners and a BIIAB National Certificate for Licensing Practitioners (Gambling).

Capacity and authority of individual making representations:

I am making this representation in the capacity and embodiment of a responsible authority as defined in Section 13(4) of the Licensing Act 2003 (as amended by Section 103 of the Police Reform & Social Responsibility Act 2011). For this purpose, and as outlined above, I represent the relevant licensing authority in whose area the above named premises are situated.

Relevance of representations:

As a responsible authority, I am making this representation in accordance with the procedure for a premises licence application detailed in Section 17 of the Licensing Act 2003. I am also making this representation at this time and in respect of the above named premises as it is my opinion that steps are necessary to promote the licensing objectives, the prevention of crime and disorder, the protection of children from harm, the prevention of public nuisance and public safety. The grounds for this opinion are outlined below.

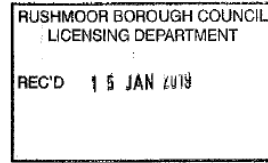

Nature and grounds of representation:

The promotion of the licensing objectives at licensed premises relies on licence holders, and DPS's having a good knowledge of the relevant legislation, and ensuring compliance with the relevant terms and conditions of the premises licence. The previous premises licence for this Restaurant lapsed on 14th August 2018, when the company who held the licence was dissolved.

The Restaurant continued to operate and sell alcohol until 14th December 2018 when Licensing Officers attended and stopped the sale of alcohol taking place. The provision of licensable activities without the requisite licence is a criminal offence, and this is currently still under investigation, and will be dealt with separately from the current licence application.

However, the above raises significant concerns as to the licence holder and DPS's regard for compliance with legislation and the promotion of the licensing objectives, as well as their knowledge and understanding of the requirements. Currently I have little confidence in the management of the premises.



Wendy Harden
Licensing Officer
Operational Services
licensing@rushmoor.gov.uk

RELEVANT CONSIDERATIONS

58 STATION ROAD ALDERSHOT HAMPSHIRE GU11 1BG

1.0 Guidance issued under S182 of the Licensing Act 2003 (April 2018)

1.1. The sections of the Secretary of State's guidance identified in **Table 1** below may be relevant to the consideration of this application.

TABLE 1 - SECTIONS OF THE SECRETARY OF STATE'S GUIDANCE WHICH MAY BE RELEVANT TO THIS APPLICATION

Section	Other Ref.	Paragraph(s)		Subject Matter	Page(s)	
		From	To		From	To
1		1.1	1.19	Introduction	1	5
2		2.1	2.6	The licensing objectives - Crime and disorder	6	7
2		2.7	2.14	The licensing objectives – Public safety	7	9
2		2.15	2.21	The licensing objectives – Public nuisance	9	10
2		2.22	2.32	The licensing objectives – Protection of children from harm	10	13
8		8.1	8.110	Applications for Premises Licence	49	67
9		9.1	9.45	Determining applications	68	76
10		10.1	10.66	Conditions attached to premises licences and club premises certificates	77	88
13		13.1	13.13	Appeals	103	105
14		14.1	14.70	Statements of licensing policy	106	120

2.0 The Council's Licensing Policy

2.1. The sections of the Council's Licensing policy identified in **Table 2** below may be relevant to the consideration of this application.

TABLE 2 - SECTIONS OF THE COUNCIL'S LICENSING POLICY WHICH MAY BE RELEVANT TO THIS APPLICATION

Section	Other Ref.	Paragraph(s)		Subject Matter	Page(s)	
		From	To		From	To
3	Part C	3.1	3.43	Licensing principals, objectives & General considerations	13	17
3	Part C	3.10	3.14	General licensing principals	14	15
6	Part F	6.1	6.53	Premises Licences	26	34
18	Part R	18.1	18.55	Representations, Responsible authorities & Interested Parties	69	74
18	Part R	18.45	18.58	The weight attached to relevant representations	73	74
19	Part S	19.1	19.27	Conditions and restrictions	76	79
19	Part S	19.10	19.15	General principles of transposition and imposition of conditions	76	77

NB: Matters in **bold** indicate main section headings.

This page is intentionally left blank